

ISOMETRIC VIEW

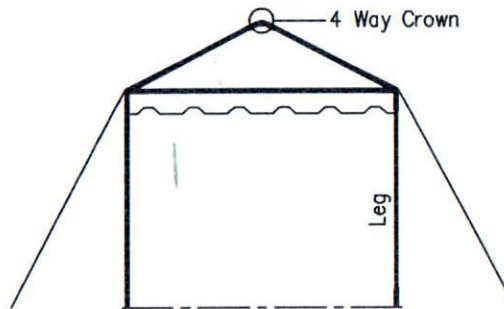

SIDE VIEW

10' x 10' FRAME TENT

- PIPE: 2"
- (4) 6'-8"/7'-8"/9'-4" LEGS
 - (4) 6'-10" HIP RAFTER
 - (4) 9'-4" WHITE SPREADER

- FITTINGS:
- (4) CORNER
 - (1) 4 WAY CROWN
- EXPANDABLE:
- (2) 3 WAY CROWNS

- OPTIONS:
- (24) ASSEMBLY PINS
 - (4) STAKES
 - (4) ROPES
 - (4) BASEPLATES
- QWIK TOP OPTIONS:
- (4) RATCHET TENSIONERS
 - (4) QWIK BASEPLATES

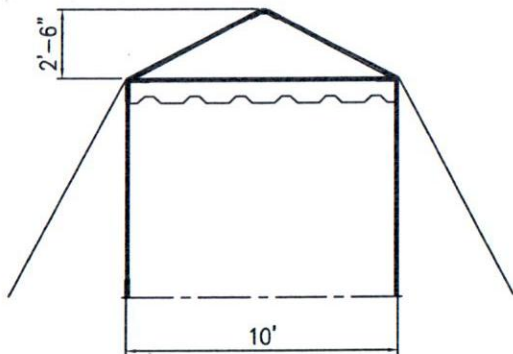

END VIEW

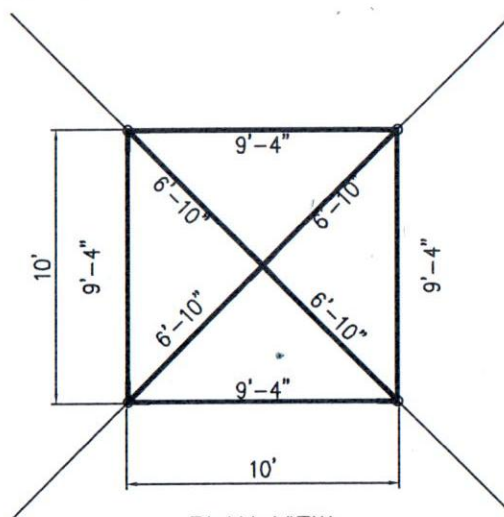

PLAN VIEW

STANDARD				FRAME TENT / STANDARD				10' x 10'				DRAWING NUMBER				REV			
PART DESCRIPTION				FRAME				AZ-1010-FRAME				CODE				0			
DRAWN				CM				KT				DATE				06/28/06			
CHECKED																			
<p>ALL DATA AND INFORMATION CONTAINED IN OR DISCLOSED BY THIS DOCUMENT IS CONFIDENTIAL AND PROPRIETARY INFORMATION OF AZTEC TENTS. BY ACCEPTING THIS MATERIAL, THE USER AGREES TO HOLD AZTEC TENTS HARMLESS FROM ANY AND ALL LIABILITY, INCLUDING BUT NOT LIMITED TO, LOSS OF PROFITS, REVENUE, REPUTATION AND WILL NOT BE COPIED, REPRODUCED WHOLE OR IN PART, FOR ANY PURPOSES WITHOUT THE WRITTEN PERMISSION OF AZTEC TENTS. THIS INFORMATION IS PROVIDED FOR YOUR INFORMATION ONLY AND IS NOT TO BE USED FOR ANY OTHER PURPOSE FOR WHICH IT WAS DELIVERED.</p>																			
<p>480 ALASKA AVE. TORRANCE, CA 90503 (800) 228-5887 - FAX (310) 381-0722</p>																			
<p>FRAME TENTS\DIAGRAMS\10x10x10.dwg, 2/28/2007 9:59:16 AM, pdfFactory.pc3</p>																			