

40'x Diagrams- Hip Style

JUMBOTRAC\40x\40x40		040208 1630	CHECKED -	DATE 06/13/07
ENGINEER CM		DATE 06/13/07	DRAWN KT	
2665 COLUMBIA ST. TORRANCE, CA. 90503 (800) 228-3687 - FAX (310) 381-0722		AZTEC		
PART DESCRIPTION		CODE	SIZE	DRAWING NUMBER
JUMBOTRAC STRUCTURE / STANDARD			40'W x 40'L x HIP ENDS	AZ4040 - JUMBOTRAC 2
REV		DRAWING NUMBER		
STANDARD				

ALL DATA AND INFORMATION CONTAINED IN OR DISCLOSED BY THIS DOCUMENT IS CONFIDENTIAL AND PROPRIETARY INFORMATION OF AZTEC TENTS AND ALL RIGHTS THEREIN ARE EXPRESSLY RESERVED. BY ACCEPTING THIS MATERIAL THE RECIPIENT AGREES THAT THIS MATERIAL AND INFORMATION CONTAINED THEREIN IS HELD IN CONFIDENCE AND IN TRUST AND WILL NOT BE COPIED, REPRODUCED WHOLE OR IN PART, OR ITS CONTENTS REVEALED IN ANY MANNER TO OTHERS, EXCEPT TO MEET THE SPECIFIC PURPOSE FOR WHICH IT WAS DEVELOPED.

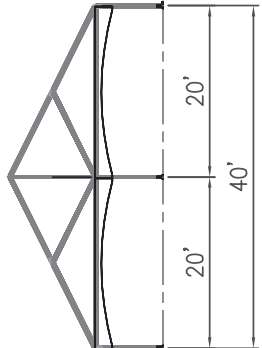

SIDE ELEVATION

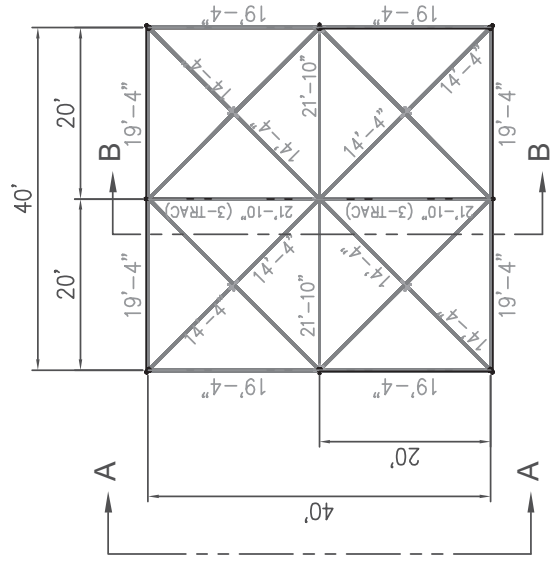

PLAN ELEVATION

- (8) JUMBOTRAC BASE PLATE
- (1) ASSEMBLY CABLE
- (8) RATCHET TENSIONERS
- (8) MID-SPAN TENSIONERS
- (12) 2" IN LINE RATCHETS
- (8) STAKE WITH HEAD
- (1) FABRIC TOOL

40' x 40' JUMBOTRAC

- FITTINGS:
- (4) CORNERS
 - (1) 8-WAY CROWNS
 - (2) SPECIAL 'T' FITTING (NO CAP)
 - (2) SPECIAL 'T' FITTING (WITH CAP)
 - (4) HIP INTERMEDIATE
 - (9) BEAM BRACE

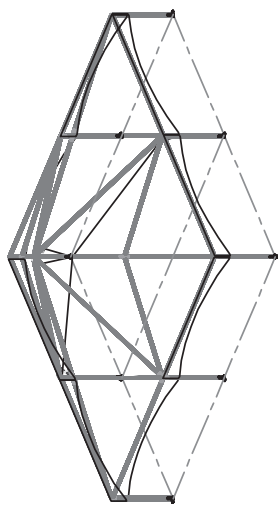

ISOMETRIC ELEVATION

- FRAME: JUMBOTRAC
- (8) 9'-4" JT3 / 7'-8" JT3 (LEGS)
 - (2) 21'-10" 1-TRAC BEAM
 - (2) 21'-10" 3-TRAC BEAM
 - (16) 14'-4" 1-TRAC BEAM
 - (8) 19'-4" 1-TRAC BEAM ORANGE

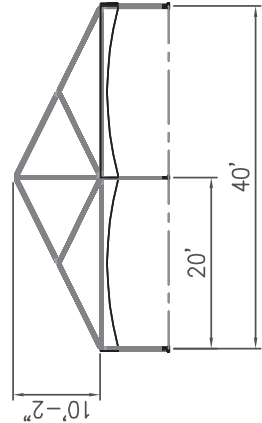

VIEW A-A

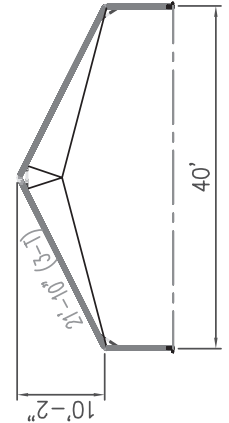

VIEW B-B

K:\cad files\Fram Tents\Jumbo trac\40x40x40.dwg, 4/2/2008 4:32:01 PM, pdfFactory.pc3