

ISOMETRIC ELEVATION

FRAME: JUMBOTRAC

- (10) 7'-8"/9'-4" 3-TRAC (LEGS)
- (2) 21'-10" 1-TRAC BEAM
- (4) 21'-10" 3-TRAC BEAM
- (16) 14'-4" 1-TRAC BEAM
- (11) 19'-4" 1-TRAC BEAM

40' x 60' JUMBOTRAC

FITTINGS:

- (4) CORNERS
- (2) 8-WAY CROWNS
- (2) SPECIAL 'T' FITTING (NO CAP)
- (4) SPECIAL 'T' FITTING (WITH CAP)
- (4) HIP INTERMEDIATE
- (12) BEAM BRACE

- (10) JUMBOTRAC BASE PLATE
- (2) 40' ASSEMBLY CABLE
- (10) RATCHET TENSIONERS
- (10) MID-SPAN TENSIONERS
- (14) 2" IN LINE RATCHETS
- (10) STAKE WITH HEAD
- (1) FABRIC TOOL

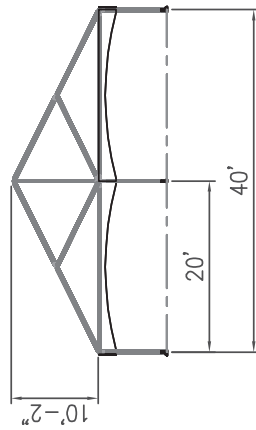

TYPICAL END

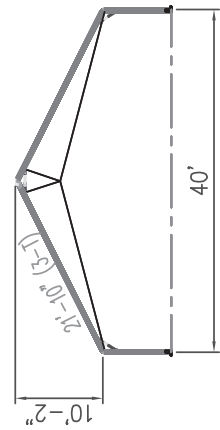

TYPICAL CENTER BEAM

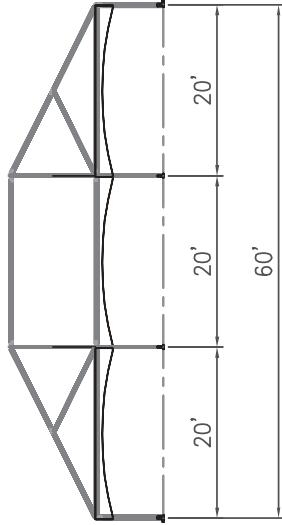

SIDE ELEVATION

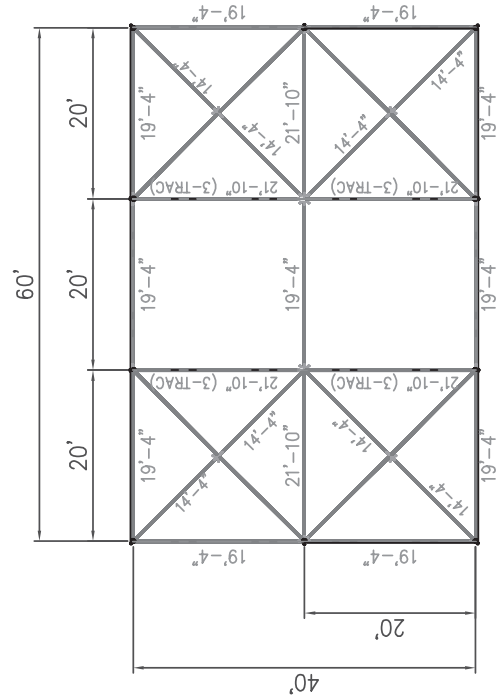

PLAN ELEVATION

JUMBOTRAC STRUCTURE / STANDARD		DATE 01/21/05		CHECKED -		031008 1610	
40' W x 60' L x 20' MIDDLES		DRAWN CM		ENGINEER CM		JUMBOTRAC\40x40x60	
PART DESCRIPTION		DRAWN KT		ENGINEER CM		JUMBOTRAC\40x40x60	
CODE		DATE 01/21/05		CHECKED -		031008 1610	
SIZE		DRAWN CM		ENGINEER CM		JUMBOTRAC\40x40x60	
DRAWING NUMBER		DATE 01/21/05		CHECKED -		031008 1610	
REV		DRAWN CM		ENGINEER CM		JUMBOTRAC\40x40x60	
REV		DATE 01/21/05		CHECKED -		031008 1610	

ALL DATA AND INFORMATION CONTAINED IN OR DISCLOSED BY THIS DOCUMENT IS CONFIDENTIAL AND PROPRIETARY INFORMATION OF AZTEC TENTS AND ALL RIGHTS THEREIN ARE EXPRESSLY RESERVED. BY ACCEPTING THIS MATERIAL THE RECIPIENT AGREES THAT THIS MATERIAL AND INFORMATION CONTAINED THEREIN IS HELD IN CONFIDENCE AND IN TRUST, AND WILL NOT BE COPIED, REPRODUCED WHOLE OR IN PART, FOR ITS CONTENTS REVEALED IN ANY MANNER TO OTHERS, EXCEPT TO MEET THE SPECIFIC PURPOSE FOR WHICH IT WAS DELIVERED.



2665 COLUMBIA ST. TORRANCE, CA. 90503
 (800) 228-3687 - FAX (310) 381-0722